

## Tapware

Installation Instruction by 4D Hardware Pty Ltd

### Basin / Sink / Kitchen / Bidet Mixer

1. Place O Ring Washer over the hole on the sink / basin where the mixer is to be installed.
2. Fit the Mixer Body onto the sink / basin hole.
3. Place the Horseshoe Washer on top of the Horseshoe Plate and fit it onto the Mounting Bolt using the Mounting Nut to tighten up the mixer from the underneath of the sink / basin.
4. Install the Flexible Hoses and ensure the Flexible Hoses are hand tightened into place (**do not use spanner to tighten as it can damage the O Ring**). The Flexible Hoses are to be fitted into the correct inlets for hot water and for cold water (Red band for hot and blue band for cold).
5. It is important to flush out the water supply pipes before installing the mixer and connecting the flexible hoses to hot/cold water supply, regardless whether a stop valve and filter has been installed or not.

### Bath / Shower Mixer

1. Mount the mixer body into the wall, connect the body with the inlet and outlet pipes.
2. Install the faceplate onto the protective mixer body.
3. Fit the fixing washer on the faceplate, install the diverter onto the mixer body and tighten with a spanner.
4. Install and tighten the handle before inserting the temperature indicator.
5. Install the spout and the showerhead on the wall.

## Important Note

We do not recommend dismantling the internal parts of the mixer. All mixers have been individually tested and assembled in the factory to give the best performance and pressure tested to AS / NZ Standards.

## Warranty

Your mixer has 2 year labour and parts warranty and additional 8 years parts only warranty from the date of purchase.

## Note

Failure to comply with the following will void all warranty

1. The faulty product must be returned together with original receipt or proof of purchase to where the purchase was made within the warranty period for replacement.
2. All mixers with flexible hose connections must be installed with isolating stop valves.
3. All tapware must be installed by a licensed plumber. Water supply pipelines must be flushed prior to the connection of the flexible hoses to the isolating stop valves.
4. The warranty will not cover for defects / damages caused by improper installation, surface damage caused by improper installation, or any other reason other than genuine quality defects of the products.
5. All mixers correct working pressure is between 150 – 500 kPa.
6. Maximum hot water temperature is 75 °C.
7. Recommended minimum working pressure 150 kPa, recommended maximum working pressure 500 kPa.
8. If the water pressure exceeds or is likely to exceed 700 kPa, approved pressure limiting valve must be fitted. If the water temperature exceeds 75 °C, an approved tempering valve must be fitted.
9. Installation must comply with Australia standard AS3500.1 or relevant local authority requirements.

Imported by: **4D Hardware Pty Ltd**

Products manufactured in China by yinshengwang sanitaryware.

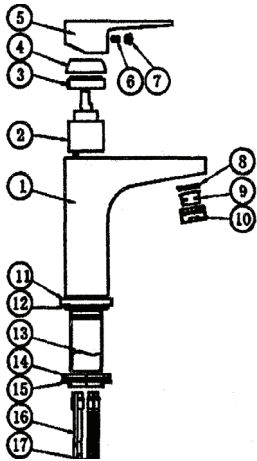

1.Body 2.Cartridge 3.Fixing Nut 4.Cartridge Bell  
5.Handle 6.Screw 7.Colour Mark 8.Washer 9.Aerator  
10.Aerator Shell 11.Base Ring 12.O-Ring 13.Threaded  
Busing 14. Washer 15.Spout Nut 16.Inlet Hose 17.  
Flexible Hose

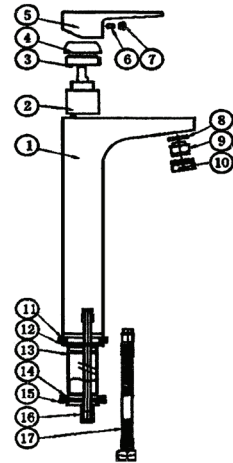

1.Body 2.Cartridge 3.Fixing Nut 4.Cartridge Bell  
5.Handle 6.Screw 7.Colour Mark 8.Washer 9.Aerator  
10.Aerator Shell 11.Base Ring 12.O-Ring  
13.Threaded Busing 14.Washer 15.Spout Nut 16.Inlet  
Hose 17.Flexible Hose

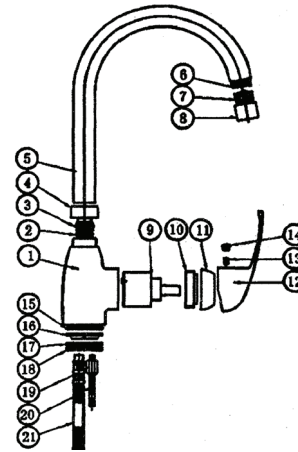

1.Body 2.Coconnector 3.O-Ring 4.Nut 5.Outlet Hose  
6.Washer 7.Aerator 8.Aerator Shell 9.Cartridge  
10.Fixing Nut 11.Cartridge Bell 12.Handle 13.Screw  
14.Colour Mark 15.O-Ring 16.Triangle Washer  
17.Washer 18.Washer 19.Nut 20.Thread Rod 21.Flexible  
Hose

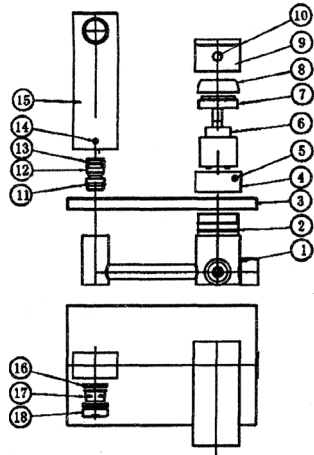
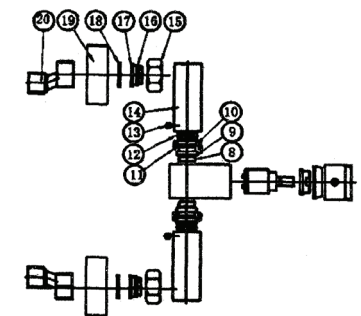
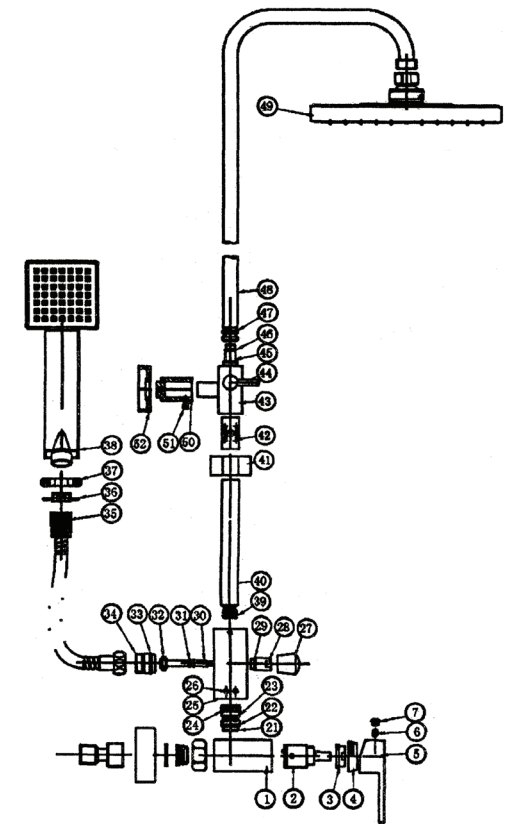

1.Body 2.O-Ring 3.Bell 4.Screw 5.Sleeve 6.Cartridge  
7.Fixing Nut 8.Cartridge Bell 9.Handle 10. Colour  
Mark 11.O-Ring 12.Connector 13.O-Ring 14.Screw  
15.Spout 16.Washer 17.Aerator Code 18.Aerator shell

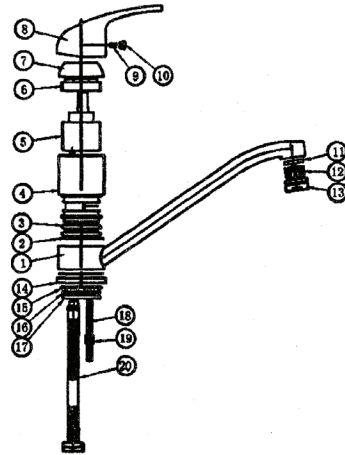

1.Outlet Hose 2.Washer 3.O-Ring 4.Body 5.Cartridge  
6.Fixing Nut 7.Cartridge Bell 8.Handle 9.Screw  
10.Colour Mark 11.Wahser 12.Aerator 13.Aerator  
Shell 14.Base Ring 15.O-Ring 16.Washer 17.Washer  
18.Threaded Rod 19.Nut 20.Flexible Hose

1.Body 2.Cartridge 3.Fixing Nut 4.Cartridge Bell  
5.Handle 6.Screw 7.Colour Mark 8.Connector  
9.O-Ring 10.Connector 11.Screw 12.O-Ring 13. Screw  
14.Inlet Hose 15.Hexagonal Nut 16.O-Ring 17.End  
Nut 18.Washer 19.Bell 20.Angle Bow 21.Connector  
22.O-Ring 23.O-Ring 24.O-Ring 25.Diverter 26.Screw  
27.Tiras Cap 28.Spout Push Button Nut 29.O-Ring  
30. Stay Link 31.O-Ring 32.O-Ring 33.O-Ring  
34.Double-nut 35.Hose 36.Throttle 37.Nut 38.Overhand  
Shower 39.O-Ring 40.Straight Pipe 41.Bracket 42.Inner  
Sleeve 43.Movable Bracket 44.Handle 45.Connector  
46.O-Ring 47.Activities Plug 48.Spout 49.Overhand  
Shower